

**Purpose:** To provide guidelines for standardized surgical attire worn in the restricted areas of the Large Animal Operating Rooms (LA OR) These policies must be followed at all times in the Large Animal surgical suites.

**Definitions:**

- A. LA OR Footwear: Clean footwear designated for use throughout the VMTH should only be worn in the operating room and scrub room, and while on shift at the VMTH, if possible. Appropriate LA OR shoes will be closed-toed, and clean of all obvious debris. In the absence of VMTH-dedicated footwear, plastic boots or overshoes must be worn over footwear during surgical procedures and whenever possible. Exceptions would be during the transport of patients into and out of the surgical room and prior to the aseptic preparation of the animal (i.e. shoe covers are required when caps and masks are worn).
  - a Rubber Boots: Rubber boots can be worn in the LA Operating room, based on surgeon preferences and IDC considerations. Boots should be cleaned in home service before entering the surgical suites.
- B. Surgical Attire: Includes hospital approved scrubs, scalp and hair covers, beard covers (if applicable), masks, scrub jackets, O.R. dedicated shoes or shoe covers.
- C. Restricted Area:
  - a VMTH & VM2 West: The restricted area includes Operating Rooms, scrub rooms, and standing surgical stocks (when occupied), as indicated by yellow lines (on floor) and accompanied signage. Masks and hair nets are required where open sterile supplies or scrubbed persons or patients are located.
    - i Figure 1 & 2
  - b VM2: Surgical attire is required at all times in the orthopedic surgery room (VMII East) and during surgical procedures, this includes scrubs, mask, head covers, and surgical shoes or shoe covers. Masks and hair nets are required where open sterile supplies or scrubbed persons or patients are located.
    - i Figure 2- indicated by the cranberry-colored lines
- D. Major Procedure:
  - a Major Surgery refers to invasive procedures that affect vital tissues, organs, or anatomic regions. This includes, but is not limited to,

- i Any procedure performed in an operating room
- ii Aseptic surgical preparation for a surgical procedure
- iii A procedure involving the individual donning of sterile gowns
- iv Any procedure that a clinician determines to be a major surgery
- v Examples include, but are not limited to, arthroscopic procedures laparoscopic procedures, orthopedic procedures, colic surgery, tube cystotomies, cesarean sections, etc.

E. Minor Procedure:

- a A procedure that is less invasive as compared to a major procedure.
  - i Examples include, but are not limited to, catheter placement (IV & Urinary), synoviocentesis, joint injections, small mass removals, etc.

**Core Policy:**

**I. Personal Protective Equipment (PPE)**

A. Head Covers

- 1. Required in restricted areas and during surgical procedures.
- 2. The scalp and hair should be fully covered.
- 3. Disposable head covers should be changed out when they become contaminated or and disposed of after the sterile procedure is over.
- 4. All non-disposable head covers (cloth) should be changed daily and when contaminated.

B. Beard Covers

- 1. Required in restricted areas.
- 2. If present, facial hair must be fully covered.
- 3. Should be worn when an individual is engaged in a sterile field (surgical field or open sterile instrument trays) and their facial hair, not including sideburns, cannot be easily contained within a standard surgical mask.
- 4. Disposable beard covers should be changed out when they become contaminated and disposed of after the sterile procedure is over.

C. Surgical Masks

- 1. Required in restricted areas when sterile prep has begun and during surgery.
- 2. Masks should cover the entire mouth and nose and be tied securely to prevent venting.

3. Masks must be changed whenever they become soiled or wet, and between surgical procedures and patients.
  4. Masks should be removed by handling only the ties and discarded into the appropriate waste receptacle.
- D. Operating Room Shoes and Shoe Covers
1. Required in restricted areas and during surgical procedures.
  2. Shoe covers
    - a. Worn when dedicated O.R. shoes are not available.
    - b. Plastic boot covers may be worn in lieu of shoe covers or when necessary based on the surgical procedure (colic surgeries, surgeries with high volume fluid use or anticipated hemorrhage, IDC concerns, etc.).
    - c. Shoe covers should be removed when leaving the operating room suite and discarded into the appropriate waste receptacle.
  3. LA OR footwear
    - a. VMTH dedicated footwear are waterproof, submersible footwear (i.e. rubber boots) and must be left in locker rooms and only used for while working at the VMTH.
    - b. Open-toe shoes or shoes with holes should not be worn in the O.R.
    - c. Cleaning;
      - i. VMTH footwear worn within the surgical environment should be clean with no visible soiling
      - ii. Shoes must be replaced if they develop holes
      - iii. VMTH dedicated shoes should be scrubbed and disinfected if they become soiled.
      - iv. VMTH dedicated shoes should be disinfected weekly or as needed.
- E. Clothing
1. The hospital provides clean, facility approved, surgical attire (scrubs) for staff.
    - a. Scrubs are Required in restricted areas and during surgical procedures.
    - b. Personal should change once on premises at the VMTH into clean scrubs.
    - c. Only surgical attire approved by the hospital may be worn.
      - i. Surgical attire, including jackets/lab coats, should be made of low-linting material. Attire made of 100% cotton fleece should not be worn.

2. Scrub attire should be changed at a minimum daily or whenever visibly soiled, or after a case with potential infectious diseases present.
3. Street clothes are not to be worn in the restricted areas or during surgical procedures.
  - a. If occasion arises when personnel have to enter surgical suite without scrubs, disposable surgical gowns must be worn over clothing.
4. Surgical scrubs should completely cover all personal attire.
  - a. Regular clothing may be worn underneath the scrub top as long as the neck and sleeves do not extend more than one inch past the surgical scrub uniform.

## **II. Personal Articles**

### **A. Jewelry**

1. Major Procedures:
  - a. All scrubbed personnel must remove all jewelry. Exceptions include:
    - i. Necklaces and body jewelry may be worn only if it can be contained/confined underneath the surgical gown or mask without becoming exposed and compromising the sterile field.
    - ii. Studded earrings are allowed. Non-studded, or any ear jewelry that hangs below the ear lobe, earrings must be removed prior to scrubbing in.
    - iii. Rings other than plain bands are discouraged for healthcare workers. Bands may be left in place while washing hands.
2. Minor Procedures:
  - a. All personnel may wear jewelry as long as they do not enter the surgical field.

### **B. Bags/Backpacks**

1. Purses, large bags, suitcases or backpacks are not permitted in the restricted areas.
- C. All personal items, including cellular phones, stethoscopes, watches, pens should be cleaned with a low-level disinfectant if they become soiled with blood, bodily fluids, or other potentially infectious materials.
- D. All personal items are under the owner's responsibility and brought into the LA OR areas at their own risk.

## **III. Fingernails**

- A. Fingernails should be kept clean and neatly trimmed for all procedures
- B. Major Procedures:

1. All healthcare workers involved in aseptic procedures requiring a surgical scrub and donning of sterile gown and gloves must keep fingernails trimmed short, and should be free of polish, artificial nails and tips.
  2. Artificial nails: artificial nails including acrylic, gel, or any other nail enhancements, are prohibited in the surgical environment due to the increased risk of bacterial colonization and transmission of pathogens.
- C. Minor Procedures:
1. Nail polish if kept in good condition is allowed for healthcare workers involved in minor aseptic procedures which only requires sterile gloves.

#### **IV. Visitors**

- A. Visitors and ancillary support staff should wear appropriate PPE when in the restricted areas.
- B. Persons entering the restricted area for a brief period of time (less than 10 minutes) may use a yellow gown cover along with appropriate head covering, mask and O.R. shoes or shoe covers.

#### **V. Compliance**

- A. All members of the organization have the authority and responsibility to monitor proper surgical attire compliance.
- B. Variances should be addressed immediately.
- C. Non-compliance issues will be addressed by the local area manager or immediate supervisor.

Figure 1:

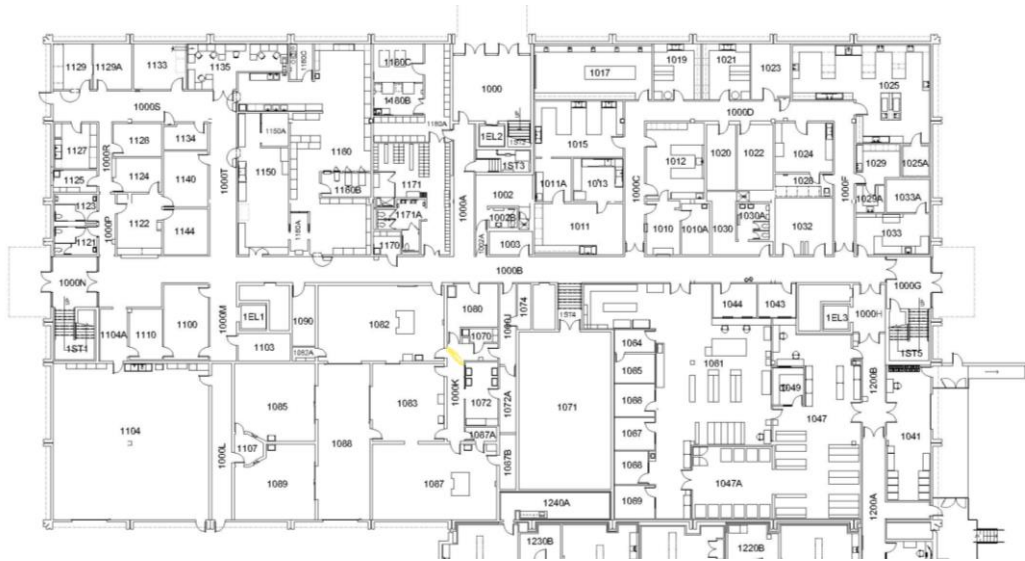

Figure 2

